

WIRING DIAGRAM

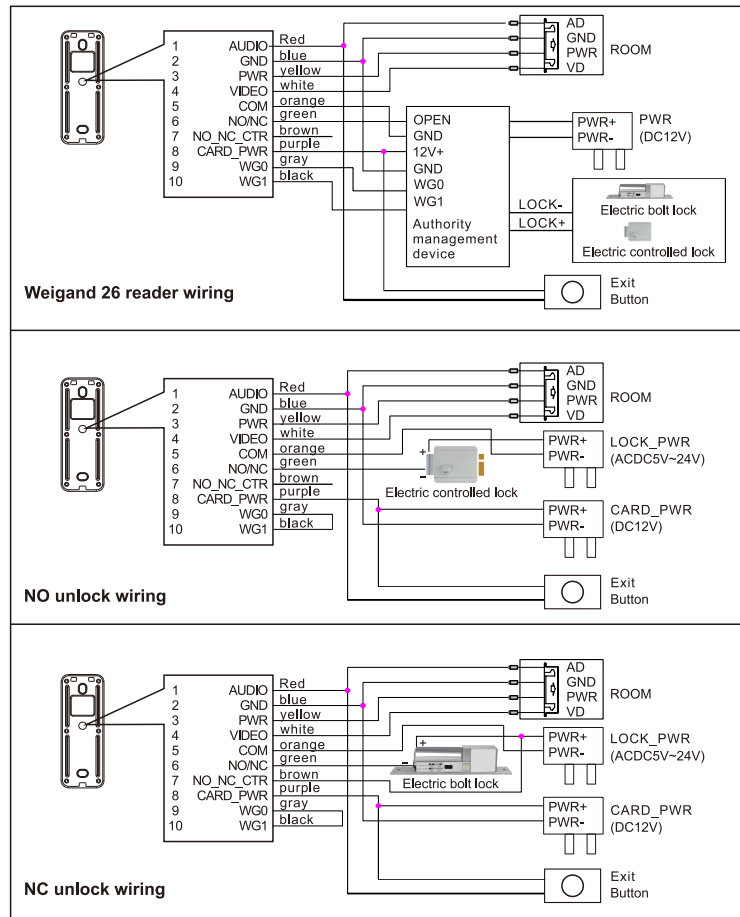

Remark:

- As WG26 reader, the blue & brown wires should not be connected together.
- There is no need extra power supply if lock power supply is DC12V.

OUTDOOR PANEL(DOORBELL) USER MANUAL

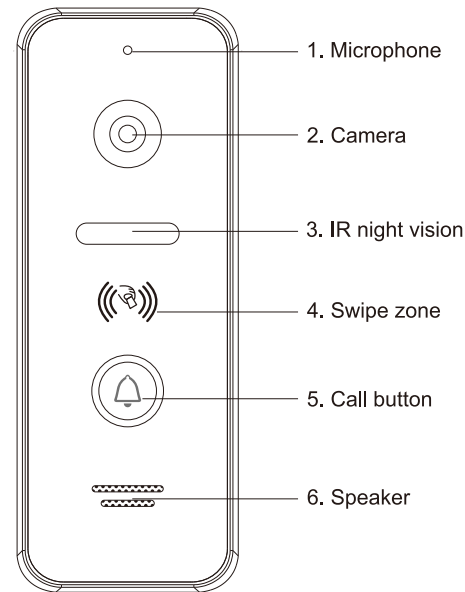

- Thank you for purchasing our products.
- The products are subject to change without prior notice.
- The company is not responsible for any safety accidents caused by abnormal operation of the product.
- Please carefully read this User's Guide(in particular, precautions for safety) before using a product and follow instructions to use a product exactly.

SPECIFICATIONS

• Surface mounting	• Dimension: 128*43*16mm
• Metal housing	• 1Vp-p75Ω video output
• 800 TV lines	• Power voltage DC 10-15V
• Color CMOS Camera	• Power consumption 2.5W
• IR night vision	• Working temperature:-30°C to +60°C
• Built-in 125KHZ (EM) reader	• Vandal-proof
• Card transmit format: WG26/ID	• Supports ISO/IEC10536
• 110° viewing angle	

Unlock Operations: Unlocking Of ID Card. When the registered user card has been shown to ID card window, the UNLOCK indicator lights up the buzzer sounds, and the electric door strike is unlocked.

Unlock Time: The unlock time is 1 second by default. The outdoor panel can update and save the real unlock time when it has detected from indoor monitor at initial unlock time.

- Connect lock, indoor monitor and outdoor panel correctly
- User enter advance setting of indoor monitor to set UNLOCK TIME
- Waiting for panel to detect the real unlock time from indoor monitor

Registering ID Card. Up to 100 user cards can be registered by the door station. Easy management with LED status and sound hints. Card reading distance is less than 3cm. The master cards are necessary when you add or delete user cards. Please keep it well for future use.

Authorizing Master Cards: For the first time to use, the BUTTON indicator will blink and buzzer sounds all the time, user show any ID card to ID card window in standby. The card can be authorized as a master card successfully if sounds do not beep. The master card can be authorized by users at anytime.

Adding User Cards: Show user cards to be added in sequence. Show user cards again to exit. The BUTTON indicator will always blink unit exit out the setting mode. If without any operation in 20 seconds, it will exit out setting mode automatically. To add user card, the access must be controlled by door station.

Deleting Master And User Cards: Show the master card to ID card window for 4 times in continuously. All cards can be deleted. The buzzer sound beeps.

Weigand 26 reader: The outdoor station work as WG26 reader, Weigand 1(blue) and ground (brown) wires should not be connected together. All cards can not be controlled by door station.

Remark: If the master card lost, disassemble the back housing, power on and press RST button to enter factory mode (all cards information are deleted) to release master card & user cards.

DOORBELL INSTALLATION

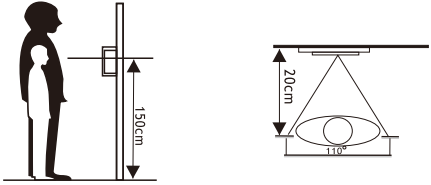

- Please select the most suitable doorbell position, avoid direct sunshine to camera, dark surroundings, rain.
- Determine doorbell installation height: suggest to be 1.5~1.6meters.

INSTALLATION DIAGRAM

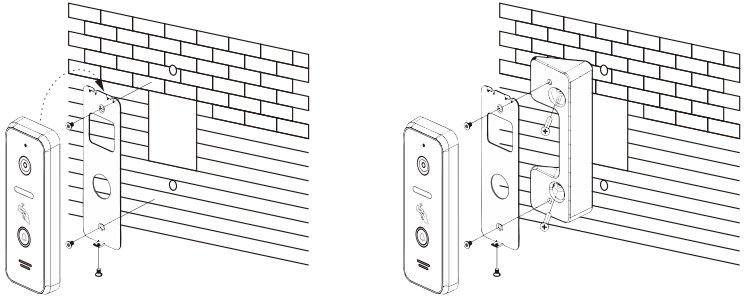

Surface mounted directly

- Dig a hole at the suitable height on the wall.
- Disassemble bracket from the outdoor panel.
- Fix the bracket on the wall with screws.
- Make the cables through the wall & bracket to connect to the doorbell connector wire.
- Put the outdoor panel onto the bracket, and fix it with the screw on the bottom.